

..puraclenz®

Core® 750

Model #C750

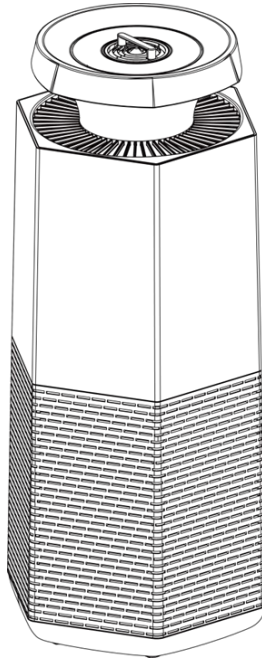

USER GUIDE

Scan the QR code with your smart phone or visit the URL below to access product registration, usage tips, and more.

puraclenz.com/GetStartedCore750



For support:

In the USA: Contact us at 1-833-360-PURA or Support@puraclenz.com

In Canada: Contact us at 855-900-8822 or Support@ogenasolutions.com

READ AND SAVE THESE INSTRUCTIONS

(Version C750-US003)

Important Safety Instructions

BEFORE USING THIS MACHINE READ ALL INSTRUCTIONS AND CAUTIONARY MARKINGS IN THIS USER GUIDE AND ON THE MACHINE.

When using an electrical machine, basic precautions should always be followed including the following:

WARNING: These warnings apply to the machine, and where applicable, to all accessories, lamps, filters, or main adapters.

TO REDUCE THE RISK OF FIRE, ELECTRICAL SHOCK, OR INJURY:

These warnings apply to the machine, and where applicable, to all accessories, lamps, filters, or main adapters.

1. This appliance can be used by children aged from 8 years and above and persons with reduced physical, sensory, or mental capabilities or lack of experience and knowledge if they have been given supervision or instruction concerning use of the appliance in a safe way and understand the hazards involved. Children shall not play with the appliance. Cleaning and user maintenance shall not be made by children without supervision.
 2. Ensure device is fully assembled in line with the instructions before use. Do not dismantle the machine by removing any screws, clasps, or other disassembly not shown in this manual. Disassembly may void the product warranty.
 3. Do not allow to be used as a toy. Close attention is necessary when used by or near children. Children should be supervised to ensure that they do not play with the device.
 4. Use only as described in this User Guide. Do not carry out any maintenance other than that shown in this manual or advised by Puraclenz Product Support.
 5. Suitable for dry location ONLY. Do not use outdoors and do not expose to water or rain.
 6. Do not handle any part of the plug or machine with wet hands.
 7. Do not operate any machine with a damaged cord or plug. Discard the machine or return to an authorized service facility for examination and/or repair. If the supply cord is damaged it must be replaced by Puraclenz, its service agent, or similarly qualified person to avoid injury.
 8. If the machine is not working as it should, has received a sharp blow, has been dropped, damaged, left outdoors, or dropped into water, do not use the device and contact the Puraclenz Helpline.
 9. Do not stretch the cord or place the cord under strain. Keep cord away from heated surfaces.
 10. Do not run cord under carpeting. Do not cover cord with throw rugs, runners or similar coverings. Do not route cord under furniture or appliances. Arrange cord away from traffic area and where it will not be tripped over.
 11. Do not unplug by pulling on the cord. To unplug, grasp the plug, not the cord. The use of an extension cord is not recommended.
 12. Do not put any object into openings or the inlet grill. Do not use with any opening blocked; keep free of dust, lint, hair, and anything that may reduce airflow.
 13. Clean the machine with a damp cloth only. Do not use any cleaning agents or lubricants on this machine. Unplug before cleaning or carrying out any maintenance. Do not let water or any other liquid or flammable detergent enter the appliance to avoid electric shock and/or a fire hazard.
 14. Always carry the machine by the Top Rim, do not carry by the Top Cover handle.
 15. Unplug from outlet when not in use for extended periods. To avoid a tripping hazard, safely coil the cord. When removing the power plug, always hold the plug and never pull the cord.
 16. Do not use near furnaces, fireplaces, stoves, or other high temperature heat sources.
 17. Do not use in conjunction with or directly next to an air freshener or similar products. Keep essential oils and chemicals away from the appliance.
 18. For cleaning and maintenance, please refer to "Maintenance Instructions" sections (page 8-11).
 19. Prior to cleaning or other maintenance, the appliance must be disconnected from the supply mains.
 20. This appliance is not a substitute for proper ventilation, use an extractor hood or fan while cooking.
 21. Please leave at least 1 ft (30cm) of free space from the wall and on each side. Please leave 1 foot (30cm) free space above the air purifier.
- CAUTION:** Changes or modifications not expressly approved by Puraclenz could void the product warranty.
WARNING: To reduce the risk of fire or electric shock, do not use this machine with any solid-state speed control device.
CAUTION: Changes or modifications not expressly approved by Puraclenz could void the product warranty.
WARNING: To reduce the risk of fire or electric shock, do not use this fan with any solid-state speed control device.

THIS MACHINE IS INTENDED FOR INDOOR USE ONLY.

NOTE: This equipment has been tested and found to comply with the limits for a Class B digital device, pursuant to Part 15 of the FCC Rules. These limits are designed to provide reasonable protection against harmful interference in a residential installation. This equipment generates, uses and can radiate radio frequency energy and, if not installed and used in accordance with the instructions, may cause harmful interference to radio communications. However, there is no guarantee that interference will not occur in a particular installation. If this equipment does cause harmful interference to radio or television reception, which can be determined by turning the equipment off and on, the user is encouraged to try to correct the interference by one or more of the following measures:

- Reorient or relocate the receiving antenna.
- Increase the separation between the equipment and receiver.
- Connect the equipment into an outlet on a circuit different from that to which the receiver is connected.

Consult the dealer or an experienced radio/TV technician for help.

This device complies with Part 15 of the FCC Rules. Operation is subject to the following two conditions: (1) this device may not cause harmful interference, and (2) this device must accept any interference received, including interference that may cause undesired operation.

WARNING: Skin or eye damage may result from directly viewing the light produced by the lamps in the apparatus. Always disconnect power before servicing. Replace Recharge Cell with Puraclenz Model#R0002.

In the Box

Top Cover and Recharge Cell®
(Puraclenz Model #R0002)

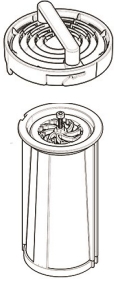

Air Quality Ring

Top Rim

Filtered Air Exhaust

Air Intake

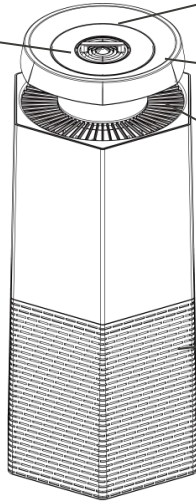

Quick Start Guide & User Manual

Core 750 Filter
(Puraclenz Model #R0010)

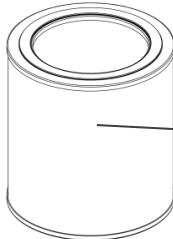

Lamp Housing

Core 750 Lamp
(Puraclenz Model #R0011)



Purifier Base

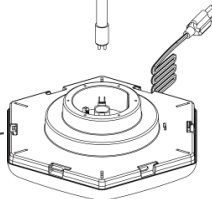

Puraclenz Core 750

Improve your indoor air quality with your Puraclenz Core 750 Air Cleaning System. Multiple technologies include a combination HEPA filter that captures allergens, PCO to actively deactivate mold spores and bacteria in the environment, Activated Carbon filter to remove odors and VOCs, and Germicidal UV to help deactivate pathogens that enter the device.

1. **PCO:** Actively treats indoor spaces with PCO ionization to deactivate mold spores, bacteria, and viruses in the environment.
2. **Pre-filter:** Captures large particles like human hair, pet dander, etc. This filtration stage is designed to help extend life of HEPA and Activated Carbon filter.
3. **True HEPA filter:** The high-performance composite HEPA filter is over 99.97 % efficient in trapping allergens and airborne contaminants down to 0.3 micron in size.
4. **Activated Carbon filter:** The activated carbon filter removes odors and other VOCs.
5. **Germicidal UV:** Designed to deactivate bacteria and viruses that make their way into the device housing.

Setup Instructions

Before operating your purifier:

1. Carefully remove your air purifier from box and plastic bag, and find the lock on the base of the purifier and slide lock mechanism to the left.
2. Lift up the top of the unit by the Top Rim
3. Remove the plastic bag from the Core Filter.

Do not run the purifier with the bag on the filter.

4. Reinsert the Core Filter and replace the top of the purifier unit.
5. Slide the lock on the base of the purifier back to the right.

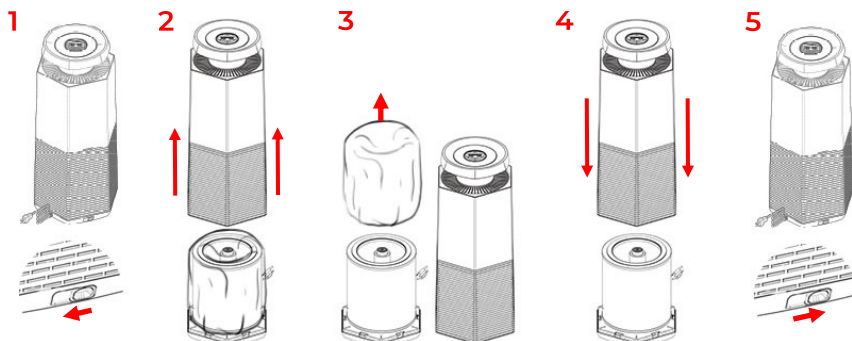

Unit Placement

For best results:

1. The Purifier unit should be placed in a central location and always stay connected to electric power. Do not connect power cord to a switched outlet or automatic timer that can stop continuous use. Purifier does not need to be right next to you for effective coverage.
2. For maximum effectiveness, results may take up to 5 days. Continue to run purifier 24/7 for continuous coverage.
3. For optimal results, set room temperature to 72°F (22°C) or higher. If possible, maintain 40-70% relative humidity. Keep windows closed for best results.
4. Ions can travel long distances but cannot move through walls and move very slowly through cracks under closed doors. Choose a central location for your purifier.
5. For proper air flow, place the unit at least 1 foot (30cm) from walls or furniture.
6. Make sure none of the intake grills or air exhausts are blocked.

IMPORTANT: When moving the air purifier, always lift unit by the carrying handle built into the Top Rim.

SCAN for
Placement
Instructions



Control Panel

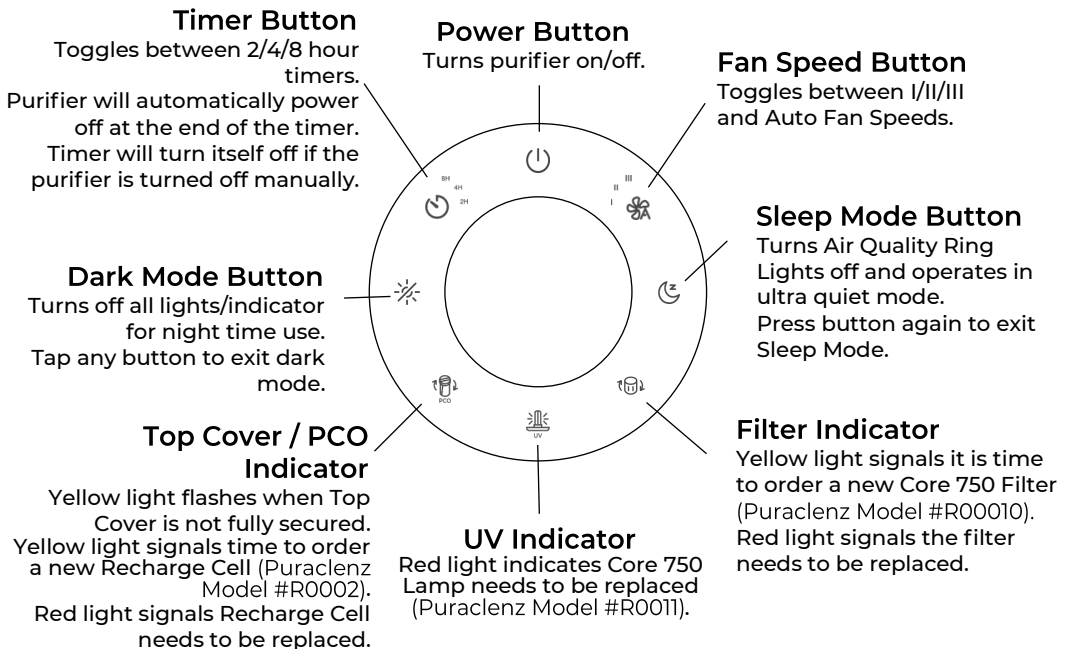

User Interface

Button Functions



1. Power Button:

Press this button to turn the unit on or switch off.



2. Fan Speed Button:

Press the button to toggle between Low(I), Medium(II), High(III), or Auto fan speed. In Auto fan speed mode, the fan speed will change automatically based on the Air Quality Monitor levels detected.



3. Sleep Mode Button:

Press this button to turn Sleep Mode on or off.

In Sleep Mode, the Sleep Mode light will turn on, the Air Quality Indicator Ring light will turn off, and the fan speed will decrease to one level below the Low(I) speed. All other indicator lights will not be affected by Sleep Mode. Press the Sleep Mode button or Fan Speed button again to exit Sleep Mode.



4. Filter Indicator:

NOTE: This is an error indicator light and it does not turn on or off the HEPA filtration during normal operation. The indicator will stay off during normal use.

The Filter Indicator will turn yellow to alert you that the filter may need to be replaced soon, after 2,880 hours (approx. 4 months) of continuous use. Ordering a new Core 750 Filter (Puraclenz Model# R0010) and replacing it at this time would be advised. The Filter Indicator will turn red to alert you that the filter needs to be replaced immediately, after 4,320 hours (approx. 6 months) of continuous use. Once a new filter has been installed (see Filter Replacement section for instructions), hold down the Filter Indicator for 5 seconds to reset the filter timer. Wait for the filter indicator light to flash for 7 seconds and then turn off, which confirms the internal filter timer has been reset.



5. UV Indicator:

NOTE: This is an error indicator light and it does not turn on or off the Core Lamp during normal operation. The indicator will stay off during normal use.

The UV Indicator will turn red when the Core 750 Lamp (Puraclenz Model# R0011) has reached the end of its usable life either from detection of a damaged lamp or from reaching 20,000 operating hours counted. At this time, the Core Lamp should be replaced immediately.

User Interface

Button Functions (continued)



5. UV Indicator Button (continued):

Once a new Core lamp has been installed (see Core Lamp Replacement section for instructions), long press the UV Indicator for 5 seconds to reset the internal lamp timer.



6. Top Cover / PCO Indicator:

NOTE: This is an error indicator light and does not turn on or off the PCO function during normal operation. The indicator will stay off during normal use.

The PCO Indicator will flash on and off when the Top Cover is open or not fully engaged. The flashing will stop once the Top Cover has been installed properly. Twist the Top Cover firmly in the clockwise direction until you hear an audible click sound.

The PCO Indicator turns yellow when the Recharge Cell (Puraclenz Model# R0002) is still working but has reduced operation and needs to be replaced immediately.

The PCO Indicator turns red when your purifier unit has operated for enough hours that the Recharge Cell must be replaced and has stopped working.

Once a new Recharge Cell has been installed (see Replacing Recharge Cell section for instructions), long press the PCO Indicator for 5 seconds to reset the internal PCO timer.

7. Dark Mode Button:



Press this button to enter Dark Mode. This mode turns off all purifier lights including the Air Quality Indicator Ring. Press any button to exit Dark Mode.

NOTE: The Dark Mode button does not have an indicator light that turns on. The PCO, UV, and Filter Indicator lights will turn on when an error first occurs in Dark Mode, but can be turned off by exiting and then entering Dark Mode again.



8. Timer Mode:

This button sets the purifier to operate for 2 hours, 4 hours, or 8 hours, and will automatically turn the unit off when the timer is up. The timer function resets to no timer upon power off.

Air Quality Ring

The Air Quality Ring will change colors depending on your air quality. The sensor measures Particulate Matter sizes from 2.5-10 micron (PM 2.5-PM10):



Excellent
< 35.5 $\mu\text{g}/\text{m}^3$

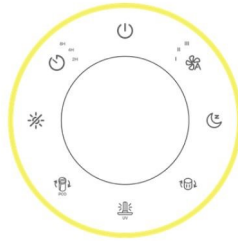

Good
35.6-55.5 $\mu\text{g}/\text{m}^3$

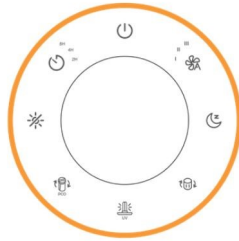

Moderate
55.6-100 $\mu\text{g}/\text{m}^3$

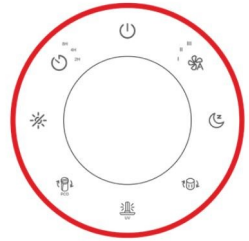

Excellent
>100 $\mu\text{g}/\text{m}^3$

Further information available at www.puraclenz.com/support

Note: The Particulate Matter sensor built into the Core 750 will detect airborne particulates (dust, mold spores, airborne bacteria, etc.) within the detection range, but will not detect VOCs, chemicals, or some odor compounds.

Maintenance and Care

Cleaning

The machine should be cleaned at least once every month by a clean, dry, soft cloth. More frequent cleaning may be required depending on environmental conditions.

NOTE:

Do NOT stick any foreign objects or your fingers into the unit.

Do NOT use petroleum-based solvents, benzene, chemical thinner, or other harsh cleaners on and/or in the unit as they will damage the product.

NEVER use alcohol or other solvents on this device.

Filter Maintenance

The outside screen of the filter is a pre-filter and should be cleaned once a month by vacuum cleaner.

Note: Filters should be replaced at least once every 6 months. More frequent cleaning and replacement may be required depending on environmental conditions. Only use official Puraclenz Core 750 Filters (Puraclenz Model #R0010).

Replacing the Recharge Cell

Disconnect power before doing any work to your Purifier unit.

SCAN for

Change Recharge
Cell Instructions



1. Turn Top Cover counterclockwise (A) and remove (B).
2. Use your fingers or pliers to slide out old Recharge Cell from Purifier unit and discard.
3. Remove Red Cap from bottom of new Recharge Cell (Model#R0002).
4. Slide in new Recharge Cell into Purifier unit by aligning keyholes.
5. Align the Top Cover with Puraclenz logo 30° counterclockwise to the front of the Purifier unit as highlighted in Diagram 5. Then place the Top Cover into Purifier as highlighted in Diagram 6 (A). Twist the Top Cover clockwise (B) until you hear an audible click from the safety latch (highlighted).
6. Power the unit back on, and press the PCO Indicator for 5 seconds to reset the PCO timer, as shown in Diagram 7. The yellow or red light will turn off to indicate the PCO timer has been reset successfully.

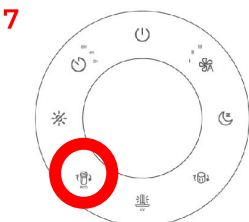
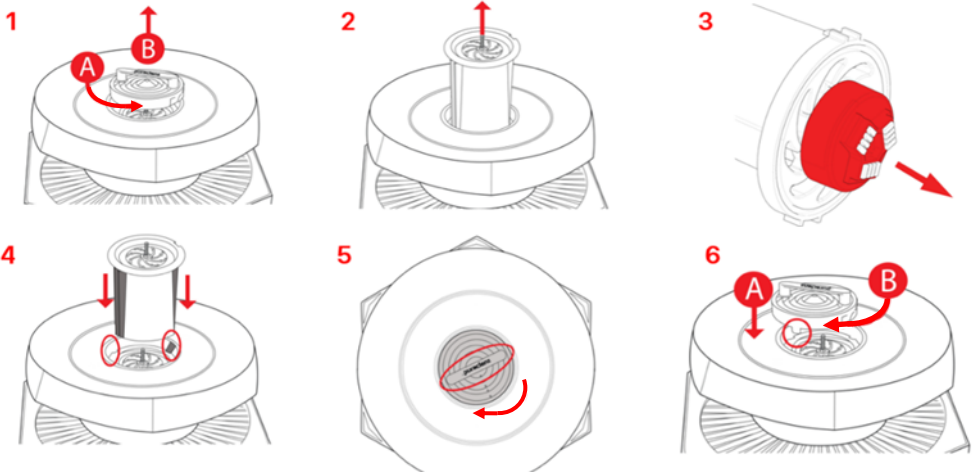

WARNING: Skin or eye damage may result from directly viewing the light produced by the lamps the Recharge Cell apparatus. Always disconnect power before relamping or servicing. Only replace Recharge Cell with Puraclenz Model# R0002.

Replacing the Core Filter

The Core Filter will last approximately 6 months in normal situations.

The outside screen of the filter is a pre-filter and should be cleaned once a month by vacuum cleaner.

The yellow Filter Indicator light comes on after 4 months of use to indicate the filter may need to be replaced soon. In environments with more particulate in the air, it may require replacement immediately. The light will turn red once filter needs to be placed after 6 months of use. Follow the instruction below to change filter and reset the filter timer.

Note: Filters should be replaced at least once every 6 months. More frequent cleaning and replacement may be required depending on environmental conditions. Only use official Puraclenz Core 750 Filters (Puraclenz Model #R0010).

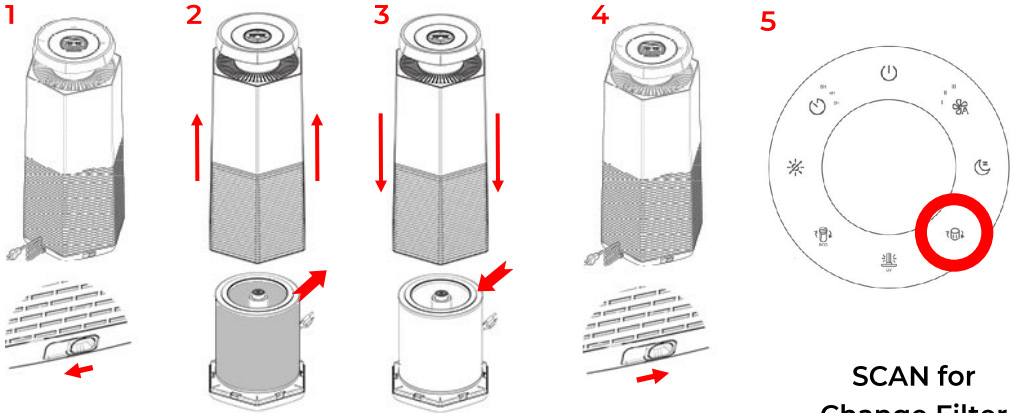

SCAN for
Change Filter
Video Instructions



To replace Core Filter:

Disconnect power before doing any work to your Purifier unit.

1. Find the lock on the base of the purifier and slide lock mechanism to the left.
2. Lift up the top of the unit by the Top Rim and discard old filter.
3. Replace new Core Filter and place top of the unit back onto the purifier base.
4. Lock the purifier by sliding the lock mechanism to the right.
5. Power the unit back on, and press the Filter Indicator for 5 seconds to reset the filter timer. The yellow or red light will turn off to indicate filter timer has been reset successfully.

Replacing Core Lamp

WARNING: Ultraviolet radiation is dangerous to eyes and skin, please do not use Germicidal UVC emitter outside the device. Please do not look into the UV lamp when it is ON. Only replace UV Lamp with Puraclenz Core 750 Lamp Model# R0011.

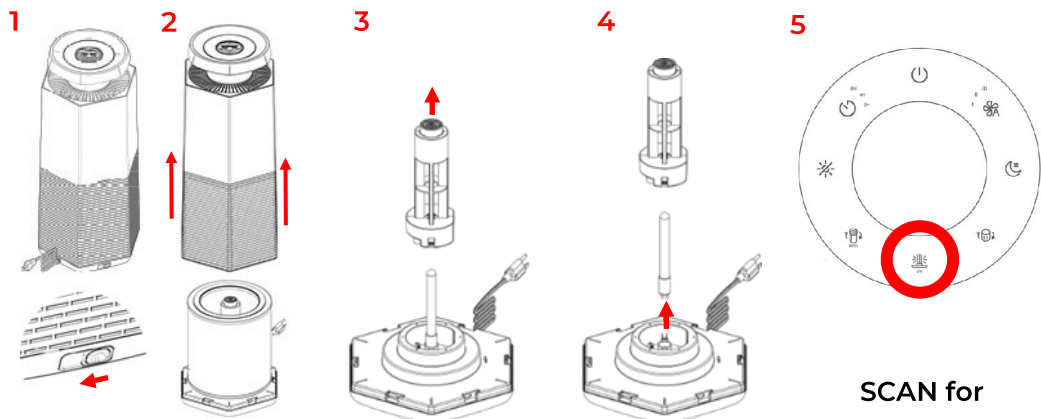

To replace the Core Lamp:

Disconnect power before doing any work to your purifier unit.

1. Find the lock on the base of the purifier and slide lock mechanism to the left.
2. Lift up the top of the unit by the Top Rim and set filter aside.
3. Remove the black Lamp Housing by pulling directly up.
4. Remove the old lamp by pulling up on the base of the Core Lamp. Recycle old Core Lamp by following your local municipality guidelines.
5. Take care to hold white portion only of new Core Lamp. Do not touch the glass tube with bare hands. Place the new Core Lamp back into the socket by aligning its pins to match socket.

Note: When installing the Core Lamp, the pins are designed to only fit in the correct orientation.

6. Reinstall the black Lamp Housing and the Core Filter, as shown in Diagram 2.
7. Replace the top of the unit and slide the lock to the right, as shown in Diagram 1.
8. Power the unit back on, and press the UV indicator for 5 seconds to reset the lamp timer, as shown in Diagram 5. The yellow or red light will turn off to indicate the lamp timer has been reset successfully.

SCAN for
Change Lamp
Video Instructions

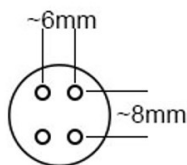

Troubleshooting

Normal Operation



Power Icon On

This shows your Purifier unit is working correctly.

All Lights Off

1. If the fan is running, the unit may have been set into Dark Mode. Press any button to exit Dark Mode.
3. Press the Power Button to turn your purifier on.
4. Check the cord and outlet to ensure the unit has power.

All Lights Off

Order New Recharge Cell



Yellow

PCO Indicator On

This indicates your Purifier unit has reduced operation and you need to replace your Recharge Cell. Order a new model #R0002. If your Recharge Cell is still under warranty, contact Puraclenz support.

Replace Recharge Cell



Red

PCO Indicator On

This shows that your Purifier unit has operated for enough hours that the Recharge Cell must be replaced. Follow instructions to replace your Recharge Cell on page 9. Once you have replaced your Recharge Cell, hold the PCO Indicator down for five seconds to reset the PCO timer.

Top Cover Open



Red

PCO Indicator Flashing

Twist your Top Cover firmly in the clockwise direction until you hear an audible click sound. See Diagram 5 on page 9.

Core Lamp Issue



Yellow or Red

UV Indicator On

This indicates your Core Lamp is having problems. Order a new Core 750 Lamp (Puraclenz Model#R0011) and replace it by following instructions on page 11. Once you have changed your Core Lamp, hold the Lamp Indicator down for five seconds to reset the lamp timer.

Filter Issue



Yellow or Red

Filter Indicator On

This indicates your Filter is reaching the end of its usable life. Order a new Core 750 Filter (Puraclenz Model#R0010) and replace it by following instructions on page 10. Once you have changed your Core Filter, hold the Filter Indicator down for five seconds to reset the filter timer.

Puraclenz LLC, P.O. Box 733, Old Greenwich, CT 06870

PURACLENZ®, CORE®, and RECHARGE CELL® are registered trademarks, all owned by Puraclenz LLC. All rights reserved © 2022, 2024.

For Patent Information go to: www.puraclenz.com/patents